

\$424,015 - 2909 Birch Park Path, Leander

MLS® #3780995

\$424,015

3 Bedroom, 2.00 Bathroom, 1,560 sqft
Residential on 0.11 Acres

Deerbrooke, Leander, TX

1-story; 3 Bedrooms, 2 Bathrooms, 2-Bay, attached alley-load garage. Kitchen features 42" gray painted cabinets, white subway tile backsplash, white quartz countertops and center island. Upgrades include, faucet, under cabinet lighting and USB port. Upgraded to include covered patio. Other upgrades include: Mahogany wood front door, ceiling fans in the great room and primary suite, extended wood-look plank tile flooring in all common areas, additional recessed lighting in primary suite, dual sinks at vanity in primary bath, decora light switches and 2" white faux wood blinds throughout and more. Knox plan, elevation B



Built in 2021

Essential Information

MLS® #	3780995
Price	\$424,015
Bedrooms	3
Bathrooms	2.00
Full Baths	2
Square Footage	1,560
Acres	0.11
Year Built	2021
Type	Residential
Sub-Type	Single Family Residence
Status	Active

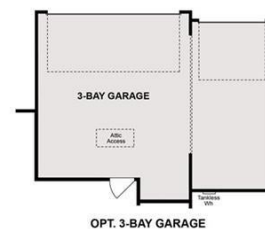
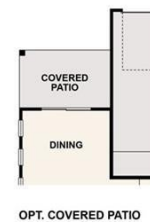

Community Information

Address	2909 Birch Park Path
Subdivision	Deerbrooke
City	Leander
County	Williamson
State	TX
Zip Code	78641

Amenities

Utilities	Cable Available, Electricity Available, Natural Gas Available, High Speed Internet Available, Phone Available, Sewer Available, Water Available, Underground Utilities
Features	Common Grounds/Area, Clubhouse, Community Mailbox, Dog Park, Fitness Center, Playground, Park, Pool, Suburban, Sidewalks, Trails/Paths
Parking	Concrete, Driveway, Detached, Garage, Lighted, Garage Faces Rear
# of Garages	2
Garages	Garage Door Opener
View	None
Waterfront	None

Interior

Interior	Carpet, Tile
Appliances	Dishwasher, Free-Standing Gas Range, Disposal, Microwave, Stainless Steel Appliance(s), Tankless Water Heater, Vented Exhaust Fan
Heating	Exhaust Fan, Natural Gas, Radiant Ceiling
# of Stories	1
Stories	One

Exterior

Exterior Features	Lighting, Private Yard
Lot Description	Alley, Back Yard, Front Yard, Sprinklers In Rear, Sprinklers In Front, Landscaped, Native Plants, Sprinkler - Rain Sensor, Sprinklers Automatic, Sprinklers In Ground, Sprinklers On Side, Trees Small Size
Roof	Composition
Construction	Attic/Crawl Hatchway(s) Insulated, Blown-In Insulation, Frame, HardiPlank Type, Masonry, Radiant Barrier, Stone, Stucco
Foundation	Slab

School Information

District	Leander ISD
----------	-------------

Elementary	Jim Plain
Middle	Danielson
High	Glenn

Property Listed by: Century Communities - CROTXThe information being provided is for consumers' personal, non-commercial use and may not be used for any purpose other than to identify prospective properties consumers may be interested in purchasing. Based on information from the Austin Board of REALTORS® (alternatively, from ACTRIS) from September 10th, 2021 at 6:16pm CDT. Neither the Board nor ACTRIS guarantees or is in any way responsible for its accuracy. The Austin Board of REALTORS®, ACTRIS and their affiliates provide the MLS and all content therein "AS IS" and without any warranty, express or implied. Data maintained by the Board or ACTRIS may not reflect all real estate activity in the market. All information provided is deemed reliable but is not guaranteed and should be independently verified.