

\$318,271 - 7114 Solar Eclipse, Converse

MLS® #1558315

\$318,271

4 Bedroom, 2.00 Bathroom, 1,694 sqft
Residential on 0.00 Acres

HORIZON POINTE, Converse, TX

Ready in Nov/Dec. This home offers a spacious great room and 9-ft. ceilings. The kitchen has 42-in. cabinets, stunning granite countertops, and stainless steel Whirlpool glass top range, microwave/hood, and dishwasher. The master bath has a separate tub and shower with tile surround and Moen faucets. Spend fall evenings outside on the covered patio. Other features include: garage door opener, soft water loop, full sprinkler system.

Built in 2021

Essential Information

MLS® #	1558315
Price	\$318,271
Bedrooms	4
Bathrooms	2.00
Full Baths	2
Square Footage	1,694
Acres	0.00
Year Built	2021
Type	Residential
Sub-Type	Single Family Detached
Style	One Story
Status	Price Change

Community Information

Address	7114 Solar Eclipse
Subdivision	HORIZON POINTE

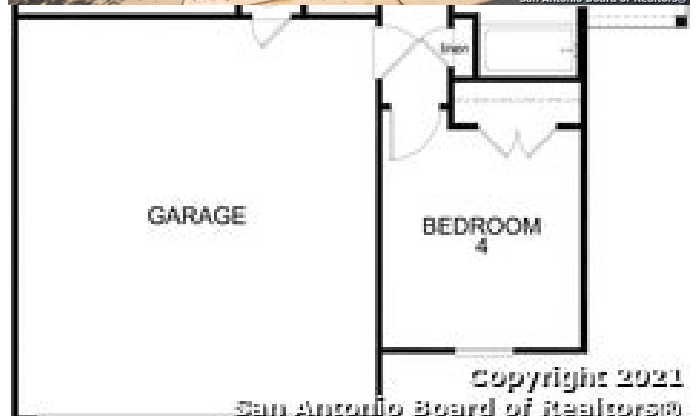

City	Converse
County	Bexar
State	TX
Zip Code	78109

Amenities

Amenities	Pool, Park/Playground
Parking	Two Car Garage
Pool	None

Interior

Interior	Open Floor Plan
Appliances	Washer Connection, Dryer Connection
Heating	Central
Cooling	One Central
Fireplaces	Not Applicable
# of Stories	1
Stories	1

Exterior

Exterior	Brick, Stone/Rock, Cement Fiber
Roof	Composition
Construction	New
Foundation	Slab

School Information

District	Judson ISD
Middle	Metzger
High	Wagner

Listing Details

Listing Office	SATEX Properties, Inc.
----------------	------------------------

The data relating to real estate on this web site comes in part from the Internet Data Exchange program of the MLS of the San Antonio Board of Realtors®, and is updated as of September 11th, 2021 at 11:30am CDT (date/time). IDX information is provided exclusively for consumers' personal, non-commercial use and may not be used for any purpose other than to identify prospective properties consumers may be interested in purchasing.