

# \$690,000 - Tbd 2e Allison Lane, San Marcos

MLS® #1553706

**\$690,000**

Bedroom, Bathroom,  
Lots and Acreage on 15.00 Acres

TRAILS END RANCH, San Marcos, TX

Single Family Residential Sub-Division for rural living at its finest. Acreage just south of Wimberley in the Trails End gated community. Ag exemption in place. Min. House size...2,000 sq' Architect approval required from the committee." No time frame to build " buy today and build when you are ready!

## Essential Information

MLS® #	1553706
Price	\$690,000
Acres	15.00
Type	Lots and Acreage
Sub-Type	Residential Lot and Acreage
Status	Active

## Community Information

Address	Tbd 2e Allison Lane
Subdivision	TRAILS END RANCH
City	San Marcos
County	Hays
State	TX
Zip Code	78666

## Amenities

Amenities	Other - See Remarks
Utilities	None

## Exterior

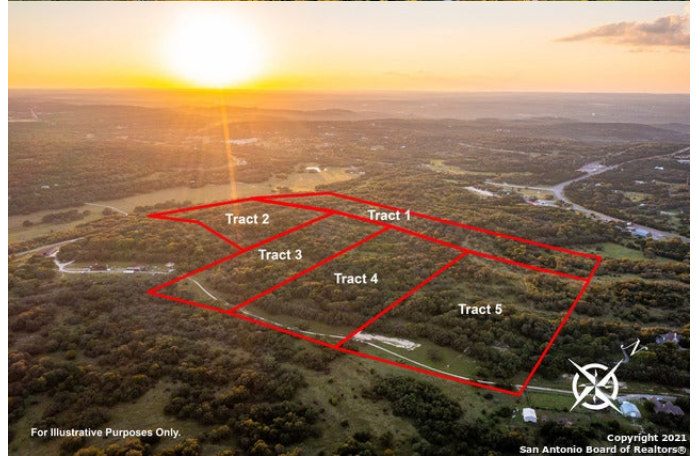

Lot Description	Partial Cleared, Wooded
-----------------	-------------------------

### **School Information**

District	CALL DISTRICT ISD
Elementary	Call District
Middle	Call District
High	Call District

### **Additional Information**

Zoning	RESIDENTIAL
--------	-------------

### **Listing Details**

Listing Office	Anders Pierce Realty
----------------	----------------------

The data relating to real estate on this web site comes in part from the Internet Data Exchange program of the MLS of the San Antonio Board of Realtors®, and is updated as of September 10th, 2021 at 3:32pm CDT (date/time). IDX information is provided exclusively for consumers' personal, non-commercial use and may not be used for any purpose other than to identify prospective properties consumers may be interested in purchasing.