

# \$369,900 - 2745 Barkey Springs, San Antonio

MLS® #1548303

## \$369,900

3 Bedroom, 2.00 Bathroom, 1,593 sqft  
Residential on 0.11 Acres

LADERA ENCLAVE, San Antonio, TX

### PERRY HOMES NEW CONSTRUCTION!

Entry leads to open kitchen, dining area and family room. Abundant natural light throughout. Kitchen features center island and corner walk-in pantry. Family room features wall of windows. Primary suite includes primary bath with dual vanities, separate glass-enclosed shower and large walk-in closet. Generous closet space adds to this three-bedroom home. Extended covered backyard patio. Mud room off two-car garage.

Built in 2021

### Essential Information

MLS® #	1548303
Price	\$369,900
Bedrooms	3
Bathrooms	2.00
Full Baths	2
Square Footage	1,593
Acres	0.11
Year Built	2021
Type	Residential
Sub-Type	Single Family Detached
Style	One Story, Ranch
Status	Price Change

### Community Information

Address	2745 Barkey Springs
Subdivision	LADERA ENCLAVE

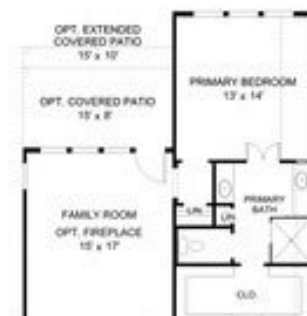

City	San Antonio
County	Bexar
State	TX
Zip Code	78245

### **Amenities**

Amenities	Pool, Golf Course, Clubhouse, Park/Playground, Jogging Trails
Parking	Two Car Garage, Attached
Pool	None

### **Interior**

Interior	One Living Area, Separate Dining Room, Eat-In Kitchen, Two Eating Areas, Island Kitchen, Breakfast Bar, Walk-In Pantry, Utility Room Inside, High Ceilings, Open Floor Plan, Pull Down Storage, Walk in Closets
Appliances	Ceiling Fans, Washer Connection, Dryer Connection, Self-Cleaning Oven, Microwave Oven, Stove/Range, Gas Cooking, Disposal, Dishwasher, Smoke Alarm, Pre-Wired for Security, Garage Door Opener, Plumb for Water Softener, Carbon Monoxide Detector
Heating	Central
Cooling	One Central
Fireplaces	Not Applicable
# of Stories	1
Stories	1

### **Exterior**

Exterior	Brick, 3 Sides Masonry, Stone/Rock
Exterior Features	Patio Slab, Covered Patio, Sprinkler System, Double Pane Windows
Roof	Composition
Construction	New
Foundation	Slab

### **School Information**

District	Medina ISD
Elementary	Potranco
Middle	Loma Alta
High	Medina Valley

### **Listing Details**

Listing Office	Perry Development Management
----------------	------------------------------

The data relating to real estate on this web site comes in part from the Internet Data Exchange program of the MLS of the San Antonio Board of Realtors®, and is updated as of September 10th, 2021 at 6:46pm CDT (date/time). IDX information is provided exclusively for consumers' personal, non-commercial use and may not be used for any purpose other than to identify prospective properties consumers may be interested in purchasing.