

\$249,990 - 909 Nodding Nixie, Seguin

MLS® #1543929

\$249,990

3 Bedroom, 2.00 Bathroom, 1,263 sqft
Residential on 0.14 Acres

ARROYO RANCH, Seguin, TX

The Ashburn is a 1,263 sq. ft. 3 bedroom, 2 bathroom single-story home. The long foyer leads into the large family room. The family room is open to the kitchen and the dining area. The kitchen features stainless steel appliances, granite countertops and decorative tile backsplash. The primary bedroom is located off the family room and includes a huge walk-in closet and walk-in shower. The secondary bedrooms are located in the front of the home next to the utility room. Enjoy the covered patio, full sod and irrigation. This home includes our HOME IS CONNECTED base package which includes the Echo Dot Voice control, Front Door Bell, Front Door Deadbolt Lock, Home Hub, Light Switch, and Thermostat.

Built in 2021

Essential Information

MLS® #	1543929
Price	\$249,990
Bedrooms	3
Bathrooms	2.00
Full Baths	2
Square Footage	1,263
Acres	0.14
Year Built	2021
Type	Residential
Sub-Type	Single Family Detached

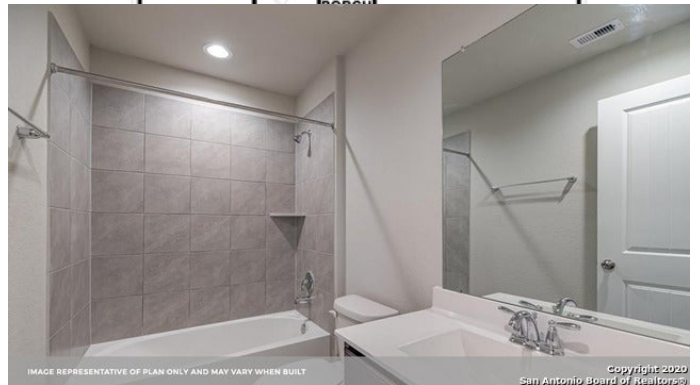
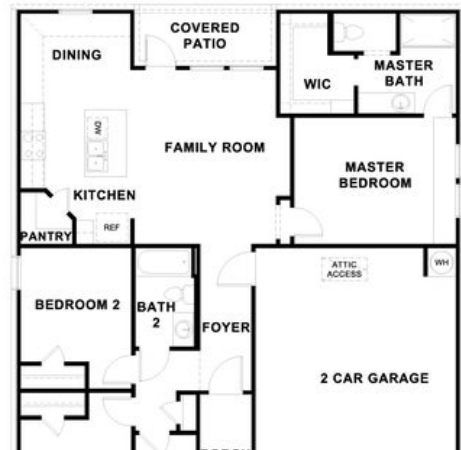

Style	One Story
Status	Pending

Community Information

Address	909 Nodding Nixie
Subdivision	ARROYO RANCH
City	Seguin
County	Guadalupe
State	TX
Zip Code	78155

Amenities

Amenities	Pool
Parking	Two Car Garage, Attached
Pool	None

Interior

Interior	One Living Area, Eat-In Kitchen, Island Kitchen, Walk-In Pantry, Utility Room Inside, Open Floor Plan, All Bedrooms Downstairs, Laundry Main Level, Walk in Closets, Attic - Radiant Barrier Decking
Appliances	Washer Connection, Dryer Connection, Self-Cleaning Oven, Microwave Oven, Stove/Range, Disposal, Dishwasher, Smoke Alarm, Pre-Wired for Security, Electric Water Heater, Carbon Monoxide Detector, City Garbage service, Solid Counter Tops
Heating	Central
Cooling	One Central
Fireplaces	Not Applicable
# of Stories	1
Stories	1

Exterior

Exterior	Brick, 1 Side Masonry
Exterior Features	Covered Patio, Sprinkler System, Double Pane Windows, Has Gutters, Privacy Fence
Lot Description	On Greenbelt
Roof	Composition
Construction	New
Foundation	Slab

School Information

District	Seguin ISD
Elementary	Vogel Elementary
High	Seguin

Listing Details

Listing Office	D.R. Horton Austin
----------------	--------------------

The data relating to real estate on this web site comes in part from the Internet Data Exchange program of the MLS of the San Antonio Board of Realtors®, and is updated as of September 11th, 2021 at 6:45pm CDT (date/time). IDX information is provided exclusively for consumers' personal, non-commercial use and may not be used for any purpose other than to identify prospective properties consumers may be interested in purchasing.