

# \$439,990 - 24306 Palermo Way, San Antonio

MLS® #1539740

## \$439,990

3 Bedroom, 2.00 Bathroom, 2,041 sqft  
Residential on 0.15 Acres

Messina, San Antonio, TX

Brand NEW energy-efficient home ready January 2022! Fire up the grill and take advantage of warm evenings outside under the Mulberry's optional covered living spaces. This thoughtful single-story layout features modern conveniences like dual pantries and a handy niche. Just minutes away from award-winning North East ISD schools, this cozy community has convenient access to major highways, shopping, dining and entertainment choices for everyone. Known for their energy-efficient features, our homes help you live a healthier and quieter lifestyle while saving thousands of dollars on utility bills.

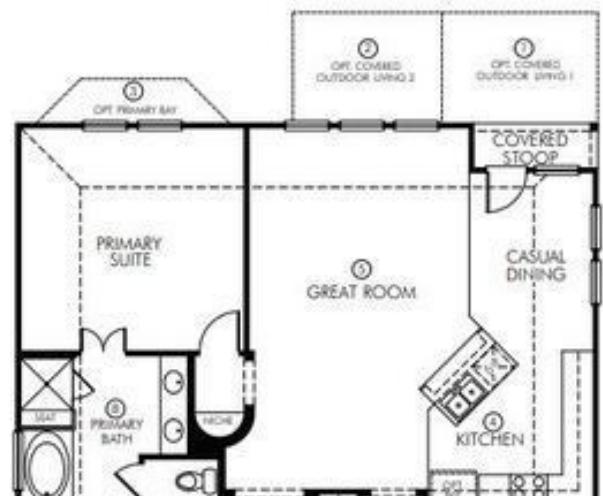

Built in 2022

## Essential Information

MLS® #	1539740
Price	\$439,990
Bedrooms	3
Bathrooms	2.00
Full Baths	2
Square Footage	2,041
Acres	0.15
Year Built	2022
Type	Residential
Sub-Type	Single Family Detached
Style	One Story
Status	Price Change

## Community Information

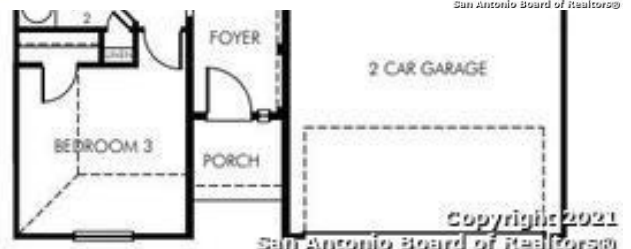

Address	24306 Palermo Way
Subdivision	Messina
City	San Antonio
County	Bexar
State	TX
Zip Code	78261

### **Amenities**

Amenities	Other - See Remarks
Parking	Two Car Garage
Pool	None

### **Interior**

Interior	1st Floor Lvl/No Steps, Cable TV Available, Eat-In Kitchen, High Ceilings, High Speed Internet, Island Kitchen, Laundry Main Level, Laundry Room, Liv/Din Combo, One Living Area, Open Floor Plan, Study/Library, Utility Room Inside, Walk in Closets, Walk-In Pantry, Telephone
Appliances	Ceiling Fans, Dishwasher, Disposal, Dryer Connection, Electric Water Heater, Garage Door Opener, Gas Cooking, Ice Maker Connection, In Wall Pest Control, Plumb for Water Softener, Solid Counter Tops, Washer Connection
Heating	Central
Cooling	One Central
Fireplaces	Not Applicable
# of Stories	1
Stories	1

### **Exterior**

Exterior	Brick, Cement Fiber, Stone/Rock, 4 Sides Masonry
Exterior Features	Covered Patio, Double Pane Windows, Privacy Fence
Roof	Composition
Construction	New
Foundation	Slab

### **School Information**

District	North East ISD
Middle	Tex Hill
High	Johnson

### **Listing Details**

Listing Office

Meritage Homes Realty

The data relating to real estate on this web site comes in part from the Internet Data Exchange program of the MLS of the San Antonio Board of Realtors®, and is updated as of September 10th, 2021 at 7:00pm CDT (date/time). IDX information is provided exclusively for consumers' personal, non-commercial use and may not be used for any purpose other than to identify prospective properties consumers may be interested in purchasing.