

# \$3,811,500 - 775 Holman Rd, Marion

MLS® #1524165

## \$3,811,500

Bedroom, Bathroom, 1,089,000 sqft  
Lots and Acreage on 25.00 Acres

RECTOR C, Marion, TX

This 25 acre tract is situated between FM 78 & IH-10 located on Holman Rd. and Santa Clara Rd. in Guadalupe County. Area is experiencing rapid residential growth and commercial development. Excellent opportunity for custom builders, new apartment complex, industrial and mix-used commercial development. Electric, Water and Natural gas onsite. Easement located at the back of the property. NO RESTRICTIONS.

## Essential Information

MLS® #	1524165
Price	\$3,811,500
Square Footage	1,089,000
Acres	25.00
Type	Lots and Acreage
Sub-Type	Residential Lot and Acreage
Status	Active

## Community Information

Address	775 Holman Rd
Subdivision	RECTOR C
City	Marion
County	Guadalupe
State	TX
Zip Code	78124-4002

## Amenities

Amenities	None
-----------	------

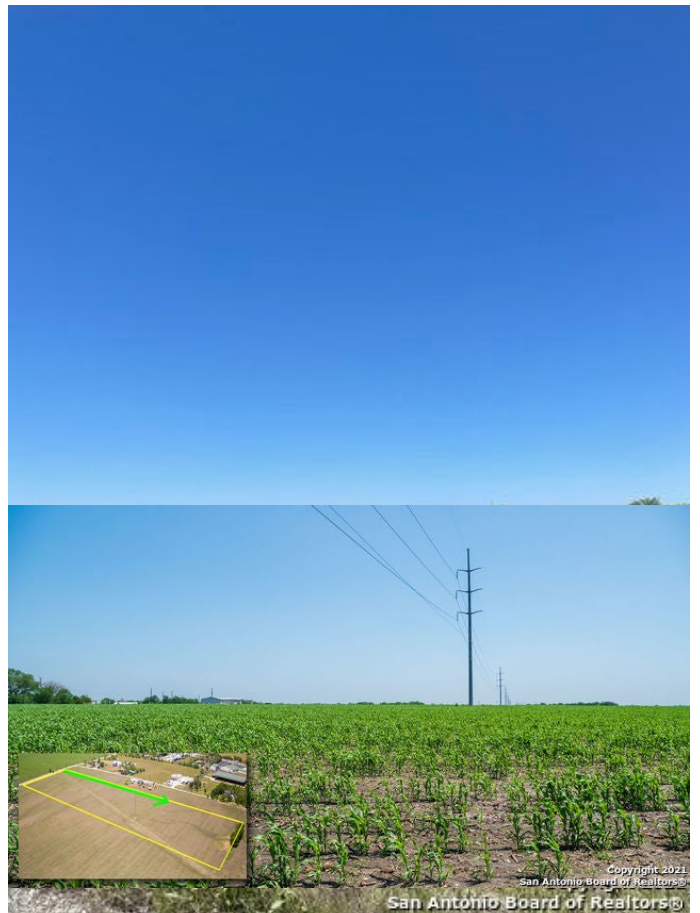

Utilities	Water System, Electric, Natural Gas
-----------	-------------------------------------

## **Exterior**

Lot Description	Improved
-----------------	----------

## **School Information**

District	Marion ISD
----------	------------

Elementary	Krueger
------------	---------

Middle	Marion
--------	--------

High	Marion
------	--------

## **Additional Information**

Zoning	AGRICULTURAL, CULTIVATED
--------	--------------------------

## **Listing Details**

Listing Office	Keller Williams Legacy
----------------	------------------------

The data relating to real estate on this web site comes in part from the Internet Data Exchange program of the MLS of the San Antonio Board of Realtors®, and is updated as of September 11th, 2021 at 11:30am CDT (date/time). IDX information is provided exclusively for consumers' personal, non-commercial use and may not be used for any purpose other than to identify prospective properties consumers may be interested in purchasing.