

\$251,000 - N Gibbs Sprawl Rd, Converse

MLS® #1299428

\$251,000

Bedroom, Bathroom, 59,416 sqft
Commercial on 1.36 Acres

N/A, Converse, TX

L shaped Property Commercial zoned, corner Lot, entries from different sides of property, have plat and survey, may be open to ground lease for certain business. Converse is opening this part of street with 4 lanes and turning lane, new lighting, looking to change area to tourist type location, changes have already started with the infrastructure.

Essential Information

MLS® #	1299428
Price	\$251,000
Square Footage	59,416
Acres	1.36
Type	Commercial
Sub-Type	Commercial Land
Status	Active

Community Information

Address	N Gibbs Sprawl Rd
Subdivision	N/A
City	Converse
County	Bexar
State	TX
Zip Code	78109

Amenities

Utilities	None
-----------	------

Additional Information

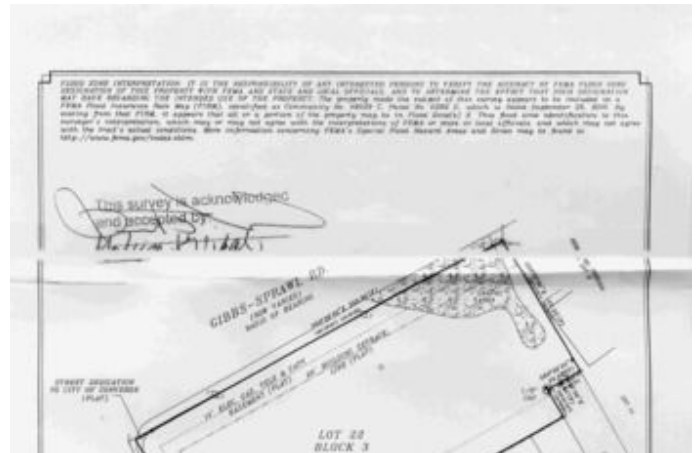

Zoning

COMMERCIAL

Listing Details

Listing Office

Texas Premier Realty

The data relating to real estate on this web site comes in part from the Internet Data Exchange program of the MLS of the San Antonio Board of Realtors®, and is updated as of September 11th, 2021 at 12:15pm CDT (date/time). IDX information is provided exclusively for consumers' personal, non-commercial use and may not be used for any purpose other than to identify prospective properties consumers may be interested in purchasing.