

# \$212,000 - 27527 N Twin Peak St, San Antonio

MLS® #1161055

## \$212,000

Bedroom, Bathroom, 217,800 sqft  
Lots and Acreage on 5.00 Acres

COUNTRY PLACE, San Antonio, TX

JUST REDUCED \$10,000. A BEAUTIFUL 5.0 ACRES LOT IN COUNTRY PLACE SUBDIVISION, WITH VIEWS AND WOODED WITH MANY MATURE OAK TREES. VERY LEVEL USABLE LAND. GREAT LOCATION NEAR PGA GOLF VILLAGE. JUST MINUTES EASY ACCESS TO HIGHWAY 281, LOOP 1604 AND HIGHWAY 46. IT HAS ACCESS TO AMENITIES: POOL, TENNIS, VOLLEYBALL, CLUBHOUSE, BBQ AREA, PARTY ROOM, PLAY GROUND, GROUND MANAGEMENT. TANK & HORSE RIDING TRAILS THROUGHOUT SUBDIVISION. VA OR FHA FINANCING APPROVED.

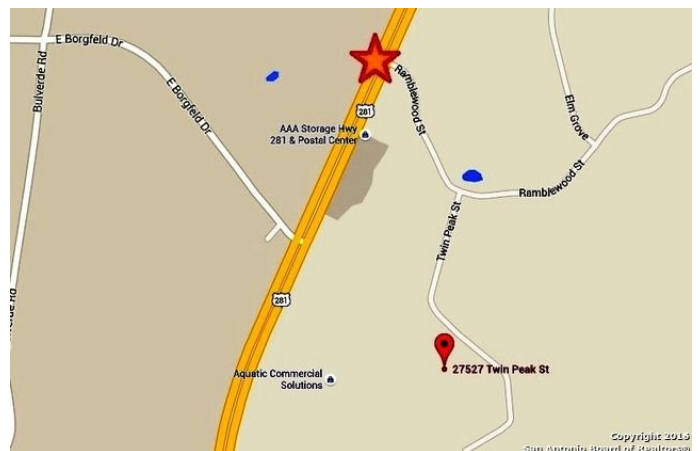

## Essential Information

MLS® #	1161055
Price	\$212,000
Square Footage	217,800
Acres	5.00
Type	Lots and Acreage
Sub-Type	Residential Lot and Acreage
Status	Active

## Community Information

Address	27527 N Twin Peak St
Subdivision	COUNTRY PLACE
City	San Antonio
County	Bexar
State	TX



Zip Code	78261
----------	-------

### **Amenities**

Amenities	None
-----------	------

Utilities	Cable TV, Electric, Natural Gas, Telephone, Solar, Well Allowed
-----------	---

### **Exterior**

Lot Description	Wooded, Improved
-----------------	------------------

### **School Information**

District	Comal ISD
----------	-----------

Elementary	Specht
------------	--------

Middle	Spring Branch
--------	---------------

High	Smithson Valley
------	-----------------

### **Additional Information**

Zoning	OCL
--------	-----

### **Listing Details**

Listing Office	World Wide Realty, LLC
----------------	------------------------

The data relating to real estate on this web site comes in part from the Internet Data Exchange program of the MLS of the San Antonio Board of Realtors®, and is updated as of September 10th, 2021 at 6:02pm CDT (date/time). IDX information is provided exclusively for consumers' personal, non-commercial use and may not be used for any purpose other than to identify prospective properties consumers may be interested in purchasing.