

# \$614,900 - 5397 Hartley Square, Schertz

MLS® #451167

## \$614,900

4 Bedroom, 4.00 Bathroom, 2,695 sqft  
Residential on 0.18 Acres

Homestead, Schertz, Texas

### PERRY HOMES NEW CONSTRUCTION!

Home office with French doors set at entry with 12-foot ceiling. Extended entry highlights coffered ceiling. Open kitchen features generous counter space, corner walk-in pantry and island with built-in seating space. Dining area flows into open family room with wall of windows. Primary suite includes bedroom with wall of windows. Dual vanities, garden tub, separate glass-enclosed shower and two large walk-in closets in primary bath. A guest suite with private bath adds to this four-bedroom home. Covered backyard patio. Mud room off three-car garage.

Built in 2021

### Essential Information

MLS® #	451167
Price	\$614,900
Bedrooms	4
Bathrooms	4.00
Full Baths	3
Half Baths	1
Square Footage	2,695
Acres	0.18
Year Built	2021
Type	Residential
Sub-Type	Single Family
Style	Traditional
Status	Active

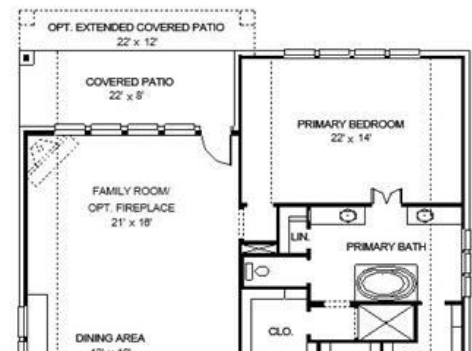

## Community Information

Address	5397 Hartley Square
Subdivision	Homestead
City	Schertz
County	Guadalupe
State	Texas
Zip Code	78108

## Amenities

Utilities	Cable Available, High Speed Internet Available
Features	Clubhouse, Playground, Park, Trails/Paths, Community Pool, Curbs, Street Lights, Sidewalks, Gutter(s)
Parking	Attached, Garage
# of Garages	3
Garages	Garage Door Opener
View	None

## Interior

Interior	Carpet, Ceramic Tile
Interior Features	Ceiling Fan(s), Carbon Monoxide Detector, Double Vanity, Garden Tub/Roman Tub, Home Office, Pull Down Attic Stairs, Separate Shower, Kitchen Island, Pantry
Appliances	Dishwasher, Disposal, Gas Water Heater, Microwave, Tankless Water Heater, Some Gas Appliances
Heating	Central, Natural Gas, Heat Pump
Cooling	Central Air, 1 Unit
Fireplaces	None
# of Stories	1
Stories	One

## Exterior

Exterior Features	Covered Patio, Rain Gutters
Lot Description	120x65
Roof	Composition, Shingle
Construction	Brick, Masonry, Stone Veneer
Foundation	Slab

## School Information

District	Schertz-Cibolo Universal City ISD
Elementary	John A Sippel Elementary

Middle	Elaine S Schlather Intermediate School
High	Byron P Steele II High School

### **Additional Information**

Date Listed	September 9th, 2021
HOA Fees	927.00
HOA Fees Freq.	Annually

### **Listing Details**

Listing Office	Perry Development Mgt.
----------------	------------------------

The information being provided by the Central Texas MLS is exclusively for consumers' personal, non-commercial use, and it may not be used for any purpose other than to identify prospective properties consumers may be interested in purchasing. The data is deemed reliable but is not guaranteed accurate by the MLS.