

\$300,000 - 4504 Jim Foley Drive, Killeen

MLS® #448117

\$300,000

4 Bedroom, 3.00 Bathroom, 2,224 sqft
Residential on 0.18 Acres

Goodnight Ranch Add Ph, Killeen, Texas

Lovely 4 bed, 2.5 bath home in the Goodnight Ranch Subdivision with a 3 car garage! This home offers 2,168 sqft. with stained concrete floors and 10' ceilings throughout. The kitchen is open to the living and dining room and offers a breakfast bar, granite counter tops, oak cabinets, a pantry, and a full compliment of stainless steel appliances. The master suite offers ultimate space to include a bathroom with dual sinks, a walk in closet, garden style tub, and an over sized glass, walk in shower with two shower heads! Two of the secondary bedrooms share a jack & jill bathroom. The back yard is enclosed with wood privacy fencing and a covered patio.

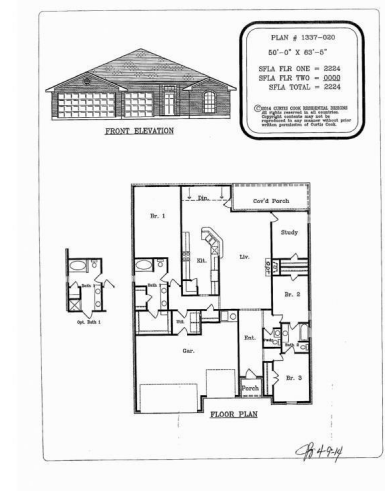

Built in 2017

Essential Information

MLS® #	448117
Price	\$300,000
Bedrooms	4
Bathrooms	3.00
Full Baths	2
Half Baths	1
Square Footage	2,224
Acres	0.18
Year Built	2017
Type	Residential
Sub-Type	Single Family
Style	Contemporary/Modern

Status	Active
--------	--------

Community Information

Address	4504 Jim Foley Drive
Subdivision	Goodnight Ranch Add Ph
City	Killeen
County	Bell
State	Texas
Zip Code	76549

Amenities

Utilities	Cable Available, Electricity Available
Features	None, Curbs, Sidewalks
Parking	Attached, Garage Faces Front, Garage, Door-Multi
# of Garages	3
View	None

Interior

Interior	Concrete, Painted/Stained
Interior Features	Ceiling Fan(s), Double Vanity, Garden Tub/Roman Tub, Open Floorplan, Pantry, Pull Down Attic Stairs, Separate Shower, Breakfast Area, Eat-in Kitchen, Tub Shower, Window Treatments
Appliances	Dishwasher, Electric Range, Electric Water Heater, Disposal, Water Heater, Some Electric Appliances, Microwave, Range
Heating	Central, Electric
Cooling	Central Air, Electric, 1 Unit
Fireplaces	None
# of Stories	1
Stories	One

Exterior

Exterior Features	Covered Patio
Windows	Window Treatments
Roof	Composition, Shingle
Construction	Brick, Masonry
Foundation	Slab

School Information

District	Killeen ISD
Elementary	Fowler Elementary School

Middle	Roy J Smith Middle School
High	Shoemaker High School

Additional Information

Date Listed	August 6th, 2021
Days on Market	34
HOA Fees	0.00

Listing Details

Listing Office	RE/MAX Homestead
----------------	------------------

The information being provided by the Central Texas MLS is exclusively for consumers' personal, non-commercial use, and it may not be used for any purpose other than to identify prospective properties consumers may be interested in purchasing. The data is deemed reliable but is not guaranteed accurate by the MLS.