

\$921,900 - 31059 Charolais Way, Bulverde

MLS® #446320

\$921,900

4 Bedroom, 5.00 Bathroom, 4,411 sqft
Residential on 0.39 Acres

Johnson Ranch, Bulverde, Texas

PERRY HOMES NEW CONSTUCTION! Entry framed by home office with French doors. Extended entry with 12-foot coffered ceiling flows past large game room with French doors and formal dining room. Spacious family room with a wood mantel fireplace opens to morning area. Island kitchen with built-in seating space, a 5-burner gas cooktop, double wall oven and a corner pantry. Secluded primary suite boasts a beautiful wall of windows. Primary bath offers dual vanities, garden tub, separate glass enclosed shower, two linen closets and two walk-in closets. Media room just off the kitchen area. Secondary bedrooms all offer full bathroom and walk-in closet. Utility room. Extended covered backyard patio. Mud room just off the three car garage.

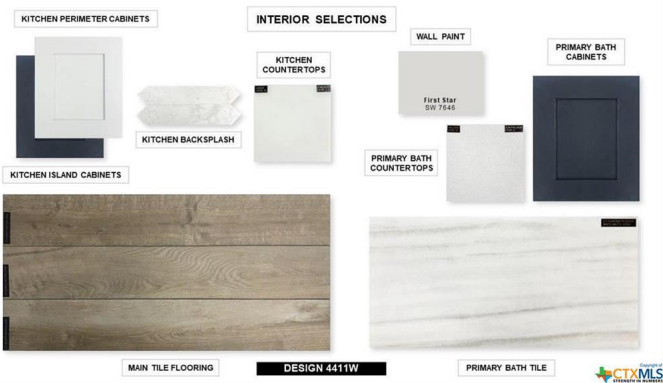

Built in 2021

Essential Information

MLS® #	446320
Price	\$921,900
Bedrooms	4
Bathrooms	5.00
Full Baths	4
Half Baths	1
Square Footage	4,411
Acres	0.39
Year Built	2021
Type	Residential

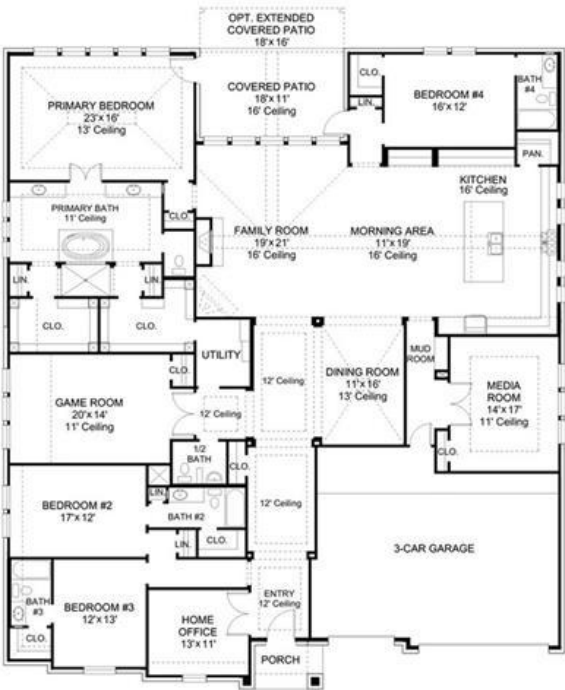

Sub-Type	Single Family
Style	Traditional
Status	Active

Community Information

Address	31059 Charolais Way
Subdivision	Johnson Ranch
City	Bulverde
County	Comal
State	Texas
Zip Code	78163

Amenities

Utilities	Cable Available, High Speed Internet Available
Features	Trails/Paths, Curbs, Gated, Sidewalks, Clubhouse, Community Pool, Park, Sport Court(s)
Parking	Attached, Garage
# of Garages	3
Garages	Garage Door Opener
View	None

Interior

Interior	Carpet, Ceramic Tile
Interior Features	Ceiling Fan(s), Carbon Monoxide Detector, Separate/Formal Dining Room, Double Vanity, Game Room, Garden Tub/Roman Tub, His and Hers Closets, Home Office, Living/Dining Room, Open Floorplan, Pantry, Pull Down Attic Stairs, Separate Shower
Appliances	Double Oven, Dishwasher, Disposal, Microwave, Some Gas Appliances, Built-In Oven, Cooktop, Gas Cooktop, Tankless Water Heater
Heating	Central, Natural Gas
Cooling	Central Air, 2 Units, Zoned
Fireplace	Yes
# of Fireplaces	1
Fireplaces	Gas Log, Gas Starter
# of Stories	1
Stories	One

Exterior

Exterior Features	Covered Patio, Rain Gutters
Lot Description	111x152

Roof	Shingle, Wood
Construction	Brick, Masonry, Stone Veneer
Foundation	Slab

School Information

District	Comal ISD
Elementary	Johnson Ranch Elementary
Middle	Smithson Valley
High	Smithson Valley High

Additional Information

Date Listed	July 22nd, 2021
Days on Market	5
HOA Fees	945.00
HOA Fees Freq.	Annually

Listing Details

Listing Office	Perry Development Mgt.
----------------	------------------------

The information being provided by the Central Texas MLS is exclusively for consumers' personal, non-commercial use, and it may not be used for any purpose other than to identify prospective properties consumers may be interested in purchasing. The data is deemed reliable but is not guaranteed accurate by the MLS.