

\$210,000 - 240 Mar Hill, Seguin

MLS® #438792

\$210,000

3 Bedroom, 2.00 Bathroom, 1,187 sqft
Residential on 0.08 Acres

Martindale Hts Sub, Seguin, Texas

SEGUIN'S NEWEST SUBDIVISION
MARTINDALE HEIGHTS NOW BUILDING
NEW HOMES! Awesome floor plans with your
choice of flooring, cabinets, color, fixtures and
more. Spacious single floor plenty of space for
your family to enjoy. Walking distance to the
park, easy access to IH 10 and 123 Bypass for
your commute to San Antonio, New Braunfels,
San Marcos and Toll road IH130. MOVE IN
READY SEPTEMBER 2021.

Built in 2021

Essential Information

MLS® #	438792
Price	\$210,000
Bedrooms	3
Bathrooms	2.00
Full Baths	2
Square Footage	1,187
Acres	0.08
Year Built	2021
Type	Residential
Sub-Type	Single Family
Style	Contemporary/Modern
Status	Pending

Community Information

Address	240 Mar Hill
Subdivision	Martindale Hts Sub

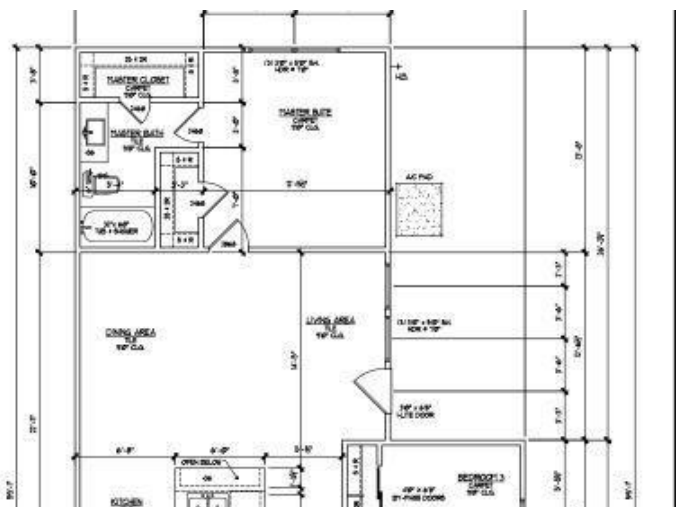

City	Seguin
County	Guadalupe
State	Texas
Zip Code	78155

Amenities

Utilities	Electricity Available, Cable Available
Features	Park
# of Garages	1
View	None

Interior

Interior	Carpet, Ceramic Tile, Laminate
Interior Features	Ceiling Fan(s), Pantry, Pull Down Attic Stairs, Tub Shower
Appliances	Electric Range, Microwave, Range Hood, Some Electric Appliances, Dishwasher, Disposal, Plumbed For Ice Maker
Heating	Electric, Central
Fireplaces	None
# of Stories	1
Stories	One

Exterior

Roof	Composition, Shingle
Construction	HardiPlank Type
Foundation	Slab

School Information

District	Seguin ISD
----------	------------

Additional Information

Date Listed	May 6th, 2021
Days on Market	19
HOA Fees	0.00

Listing Details

Listing Office	Keller Williams Heritage
----------------	--------------------------

The information being provided by the Central Texas MLS is exclusively for consumers' personal, non-commercial use, and it may not be used for any purpose other than to identify prospective properties consumers may be interested in purchasing. The data is deemed reliable but is not guaranteed accurate by the MLS.